

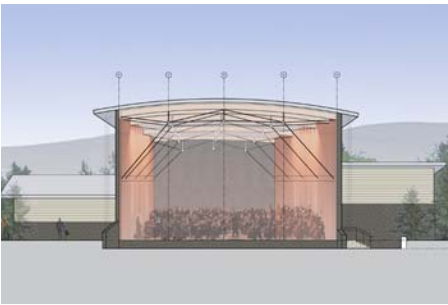

PULLMAN ARTS PAVILION

PULLMAN, WASHINGTON

CITY OF PULLMAN PUBLIC WORKS
WASHINGTON STATE UNIVERSITY MUSIC DEPARTMENT



Sited in a hollow of the rolling hills of the Palouse, the Pullman Arts Pavilion will provide a venue for symphony orchestra, chamber ensemble, theater, acoustic and amplified performance.

Designed by Jones & Jones, the Pavilion will be an acoustically balanced performance environment for audiences and performers alike. Covered and outdoor spaces will accommodate audiences of up to 2,800. Current work includes conceptual design through design development with construction documents proceeding in 2009.

Pullman Arts Pavilion will be the first venue of its kind in the Inland Empire of the Pacific Northwest.

FACTS

- Fixed, covered seating for 300
- Outdoor seating for 2,500
- Walking distance to downtown Pullman
- Adjustable performance space
- 65' X 50' covered stage to accommodate up to 70 orchestra members

BENEFITS

- Multi-purpose performing arts venue
- Regional cultural resource

JONES  JONES

ARCHITECTS
LANDSCAPE ARCHITECTS
PLANNERS