

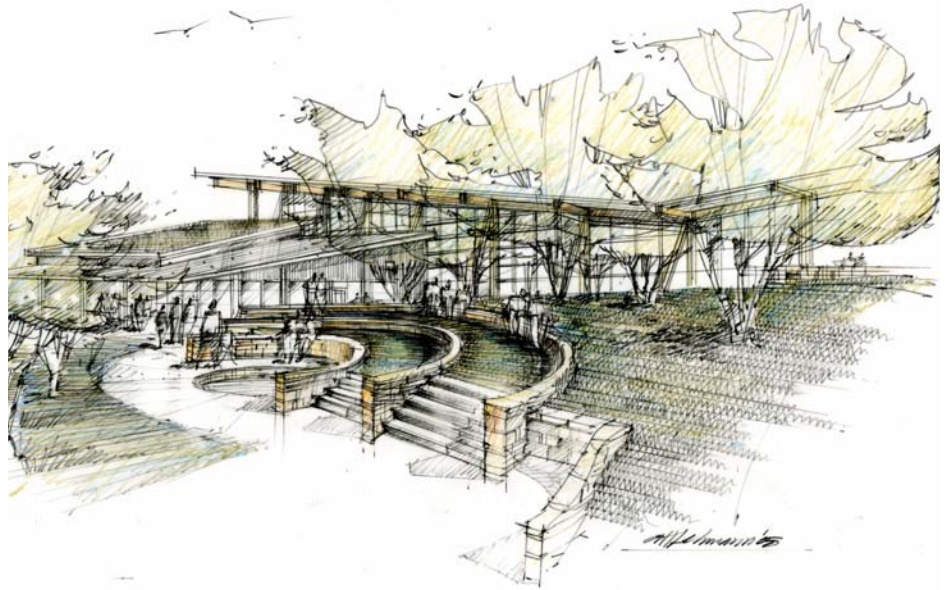

HANFORD REACH INTERPRETIVE CENTER

RICHLAND, WASHINGTON

VARIOUS FEDERAL STATE AND LOCAL GOVERNMENTS
IN PARTNERSHIP WITH COMMUNITY ORGANIZATIONS

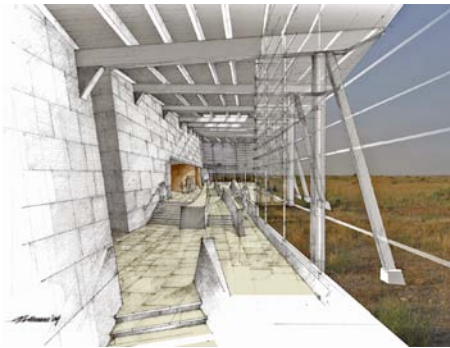

Located at the confluence of the Yakima and Columbia Rivers, the Hanford Reach Interpretive Center will be a gateway to the grandeur of the Columbia Basin and the Hanford Reach National Monument.

Jones & Jones designed this interpretive center for The Reach—a consortium of federal, state and local governments in partnership with local community organizations. The landscape, architecture and exhibit galleries will act in unison to celebrate the Hanford Reach, the mighty Columbia and the wetlands of the Yakima Delta. Building materials will honor the land and express the community's heritage.

This design partnership with diverse stakeholders will result in a learning place that tells the stories of how people shaped and have been shaped by the region's rich natural legacy.

FACTS

Integrated design of landscape, architecture and exhibit galleries

Designed for low impact on site, energy efficiency, durability and indoor environmental quality

Facilities will include:

- visitor center
- immersion theater
- exhibition galleries
- environmental learning labs
- native plant interpretive gardens
- café, museum and gift shop

BENEFITS

Inspiration for environmental and cultural stewardship

Collaboration among diverse stakeholders

JONES  JONES

ARCHITECTS
LANDSCAPE ARCHITECTS
PLANNERS