

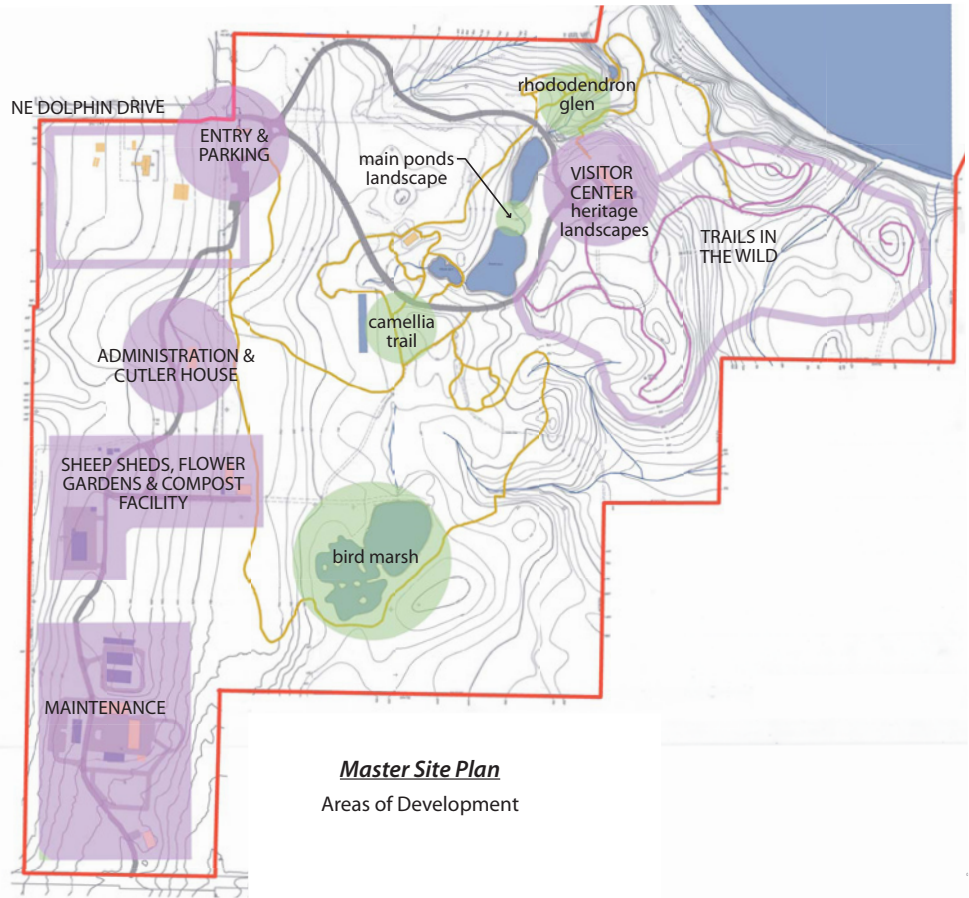

BLOEDEL RESERVE

BAINBRIDGE ISLAND, WASHINGTON

BLOEDEL RESERVE



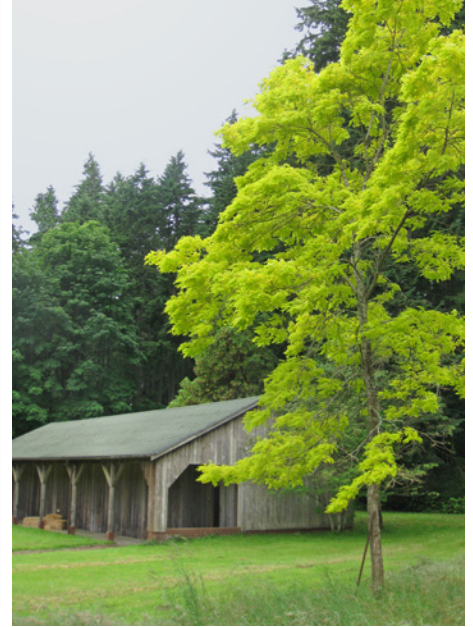
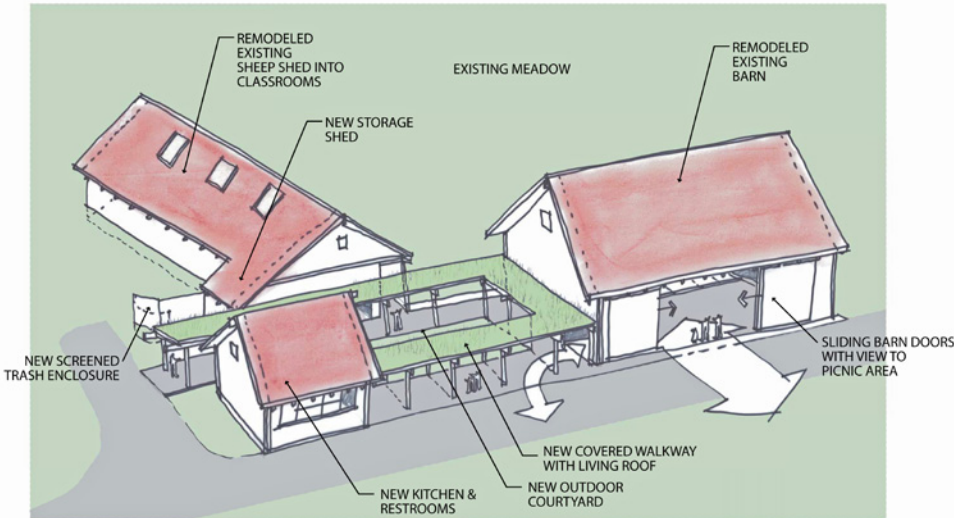

Jones & Jones is preparing a new master plan for this 150-acre internationally-acclaimed, public garden located on the north end of Bainbridge Island, just west of Seattle.

Since opening to the public in 1988, Bloedel Reserve has garnered widespread recognition from visitors worldwide for its distinctive blend of native Pacific Northwest forest and tranquil ornamental landscapes. The Reserve celebrates its 25th anniversary in 2013 and the Reserve's Board of Trustees and leadership has begun looking ahead to the next 25 years through the creation of a new Master Plan.

The purpose of this Master Plan is to provide a big picture, phased roadmap for the future restoration and enhancement of the Bloedel Reserve, including continued horticultural excellence and rehabilitation of facilities and utilities. It will serve as a platform for continuing to provide an inspiring experience

of nature and enhanced amenities for an increased number of guests. The Master Plan will focus on proper solutions for entry, parking, and circulation; infrastructure and facilities; gardens, landscapes, and trails; and visitor and staff support facilities. And it will continue Prentice Bloedel's mission to provide visitors with "refreshment and tranquility in the presence of natural beauty."